

When it is time for Tamagotchi character to return to its home planet, there is nothing you can do. But don't worry, you can always hatch another egg.

WILL YOU BE A GOOD CARETAKER FOR TAMAGOTCHI CHARACTER?

06 - 10 YEARS: Room for improvement
11 - 16 YEARS: Good job
17 - 21 YEARS: Excellent
23 + YEARS: Amazing!

In order to hatch another Tamagotchi character, press the A and C buttons simultaneously and a new pulsating egg will appear. In about 5 minutes a new Tamagotchi character will be born. Maybe you will raise a different version of Tamagotchi character this time. Try it and see.



TIMER FUNCTION

When you want to know the time, press the B button when no icons are highlighted and the time will appear on the screen. To return to the main menu screen, press the B button again.

In order to reset the time, press the B button to bring up the timer. Press the A and C buttons simultaneously and the word "SET" will appear on the screen. Then follow the same instructions used to set the timer. Press C button again to return to regular time. Press B again to return to the main screen.

NOTE: Timer cannot be adjusted if Tamagotchi character is preparing to return to its home planet.



PAUSE FUNCTION

When you need to be away from Tamagotchi character for an extended period of time, it is possible to suspend the life cycle. Push the B button to bring up the timer, push the A and C buttons simultaneously so that the word "SET" appears. While "SET" is on the screen, all functions are paused. To resume play, reset the timer to the correct time, push the C button and return to the regular life cycle.

HOW TO RESET

- 1) Press the reset button on the back of the egg with a pointed object (don't push too hard) and a new pulsating egg will appear.
- 2) Reset the timer function, as outlined in ACTIVATION step 3.

SOUND

After Tamagotchi character has hatched, the sound can be turned off by pressing the A and C buttons simultaneously. To restore the sound, press A and C again.

BATTERY

Replace the battery if the Liquid Crystal Display (LCD) is weak or when battery dies.



- 1) Loosen the screw on the back side. Remove the cover together with the screw.
- 2) Take out the old battery. Insert 1 new CR2032 (3V) battery, making sure to match "+" and "-" signs properly.
- 3) Replace the cover and tighten the screw.

Adult assembly required.

- 4) Press the reset switch on the rear of the egg with a pointed object. (Reset Operation)

- 5) Reset the timer and a new Tamagotchi character will hatch in 5 minutes.

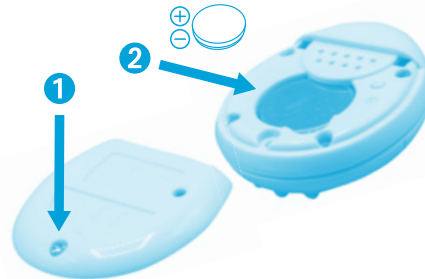

- Please also "RESET" when you can not play completely or see something wrong on the screen.

MADE IN CHINA

Distributed by Bandai America Incorporated, 2120 Park Place, Suite 120, El Segundo, California 90245. Bandai logo: © and © 2018 Bandai. TAMAGOTCHI and all related logos, names and distinctive likenesses are the exclusive property of Bandai. © BANDAI, WiZ. All Rights Reserved.

Parents and guardians: Please read this entire instruction sheet before allowing children to play.

CAUTION: PLEASE READ BEFORE PLAYING WITH TOY

- Do not: 1) aim toy at anyone, 2) hit anyone with toy, 3) poke anyone with toy, 4) swing toy at anyone, 5) step on toy.

CAUTION: Keep batteries away from children. Batteries may be harmful if swallowed. Remove and dispose of used or exhausted batteries properly. Remove batteries when not in use or discharged. Non-rechargeable batteries are not to be recharged. Rechargeable batteries are to be removed from the toy before being charged. Rechargeable batteries are only to be charged under adult supervision. Batteries are to be inserted with the correct polarity; the supply terminals are not to be short-circuited.

WARNING: CHOKING HAZARD - Small parts. Not for children under 3 years.

WARNING: This product contains a Button or Coin Cell Battery. A swallowed Button or Coin Cell Battery can cause internal chemical burns in as little as two hours and lead to death. Dispose of used batteries immediately. Keep new and used batteries away from children. If you think batteries might have been swallowed or placed inside any part of the body, seek immediate medical attention.